

Bedroom



Fall Semester/ Architectural Design III/ Villa Project

Design Staff

2023-2024

Bedrooms: It is a room where people sleep or rest. It is used for rest, sleep, dress-up, and for keeping some personal belongings. It is used for keeping important personal belongings such as money, document, clothes, jewelry, etc.

➤ The bedroom is one of the most important places in the house, there are different types of the bedroom as regards its functions and styles. The basic design of each bedroom should suit the person occupying it while being functional and comfortable.

Different Types of Bedrooms

- Master Bedroom.
- Kids' Bedroom. Kids' bedroom is used by the kids of the family.
- Guest Bedroom. Guest bedroom is used by the guests who arrive at home and stay for couple of days.
- Grandparents' Bedroom.
- Teens' Bedroom.
- Dorm Bedroom.



Occupants should also be able to conveniently carry out the following activities:

- sleeping
- reading
- watching television
- studying or using a computer
- storing clothes.

Young people in particular need space in a bedroom for private study, play and hobbies.

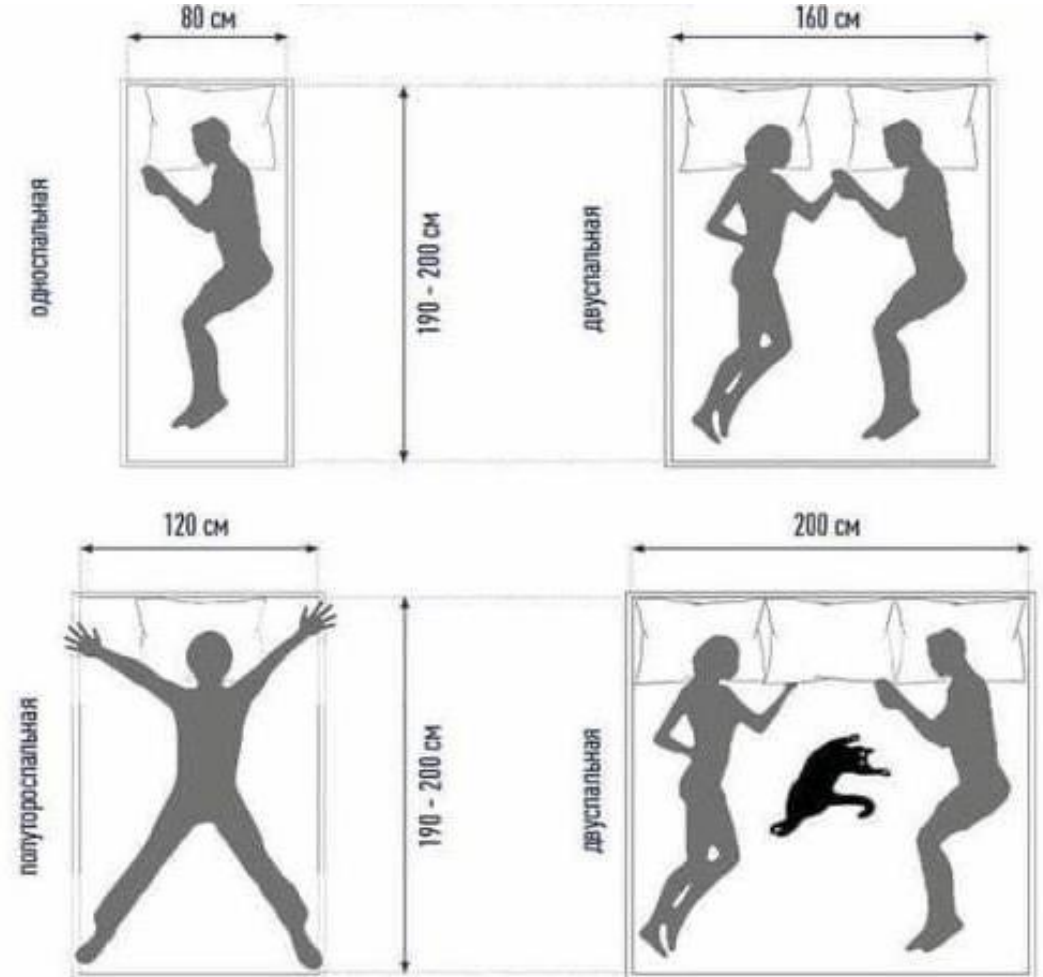



Bed sizes

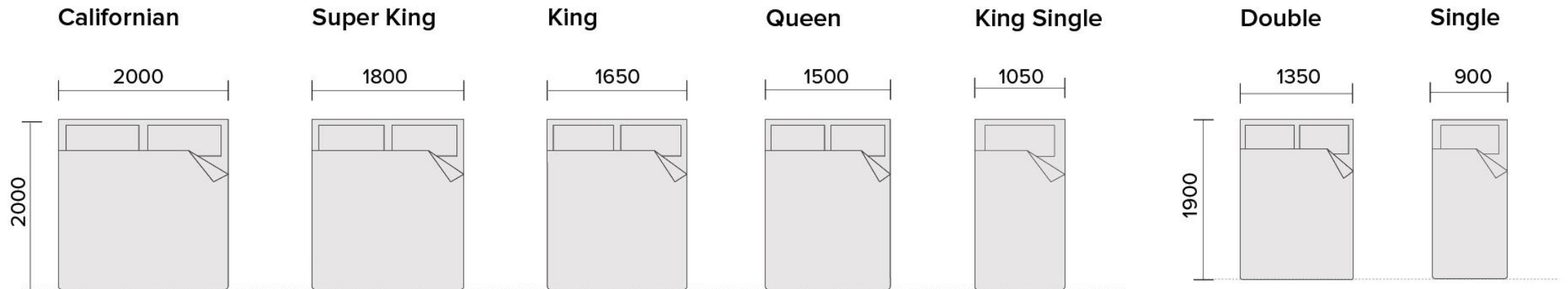
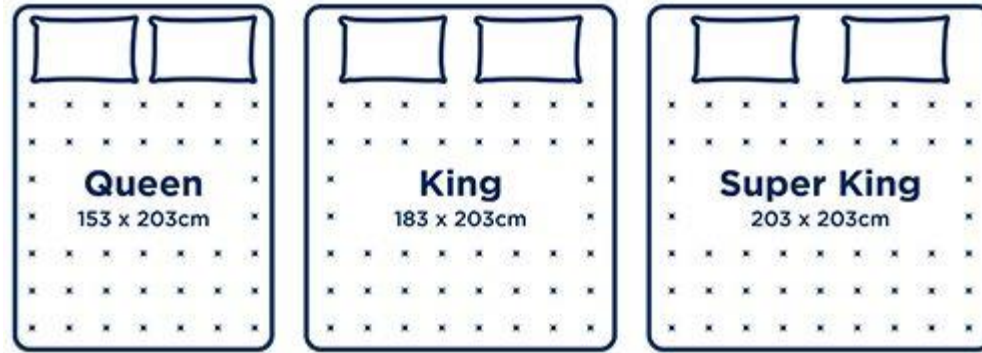

Bedroom Layout Guide

- The main purpose of bedrooms is to provide privacy. So, consider visual privacy through the bedroom windows and doors. In addition, take into account the amount of noise and disturbance entering the room.
- Keep the number of bedrooms and their respective sizes proportionate to other rooms.
- Ensure proper natural lighting and ventilation.
- Always consider bedroom furniture while designing. Ensure sufficient clearance around the bed and other furniture elements, such as dressing table, work desk, or nightstand.
- Analyze how the position of the windows works with the furniture. Windows can be split to go either side of the bed or raised above bed head level.
- Also, analyze the outside view from inside the bedroom. Aim for a pleasant view without hindering privacy.
- Evaluate the position of the bed and other furniture with respect to the doors of the bedroom, closet, and ensuite bathroom.

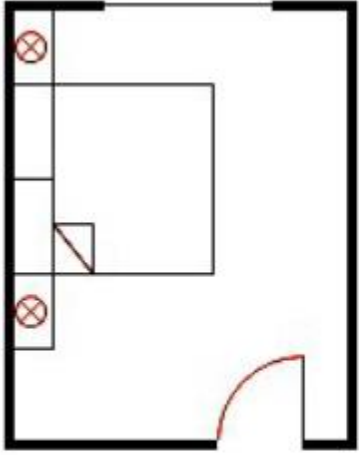

Comfortable door placement

1

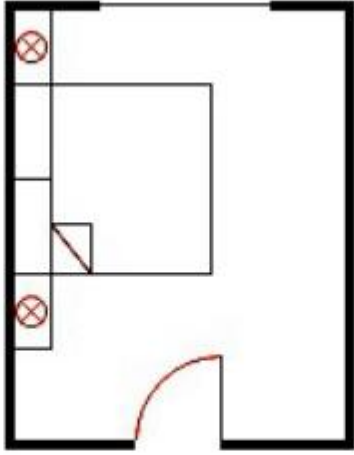

Comfortable door placement

2

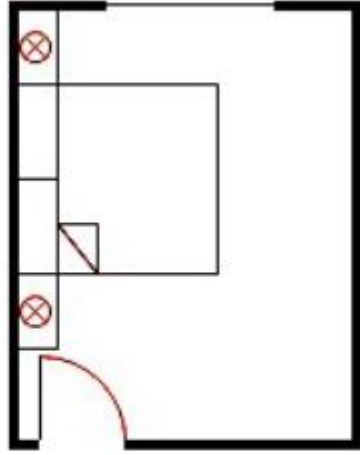

Uncomfortable door placement

3

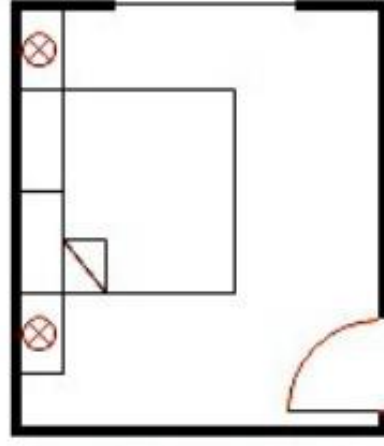

Comfortable door placement

1

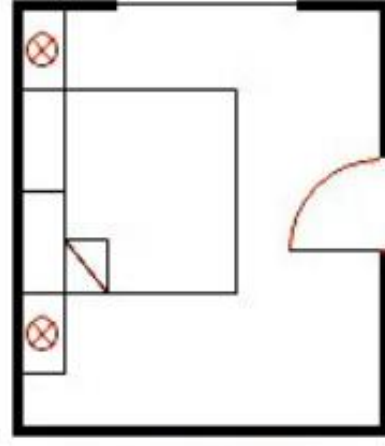

Uncomfortable door placement

2

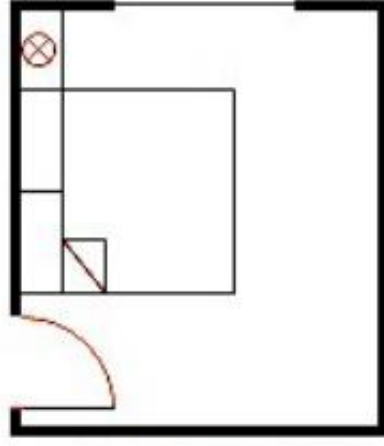

Uncomfortable door placement

3

For a two-person bedroom, a 2.8m minimum dimension gives little plan flexibility and no room for drawers or a desk, as illustrated below.

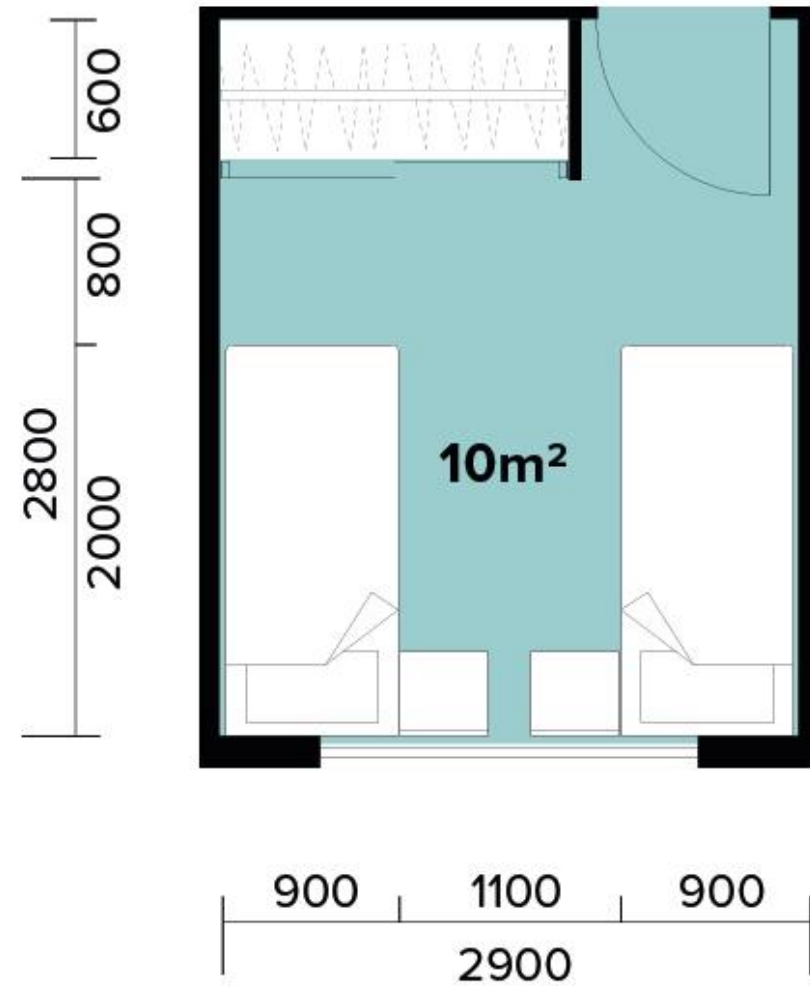
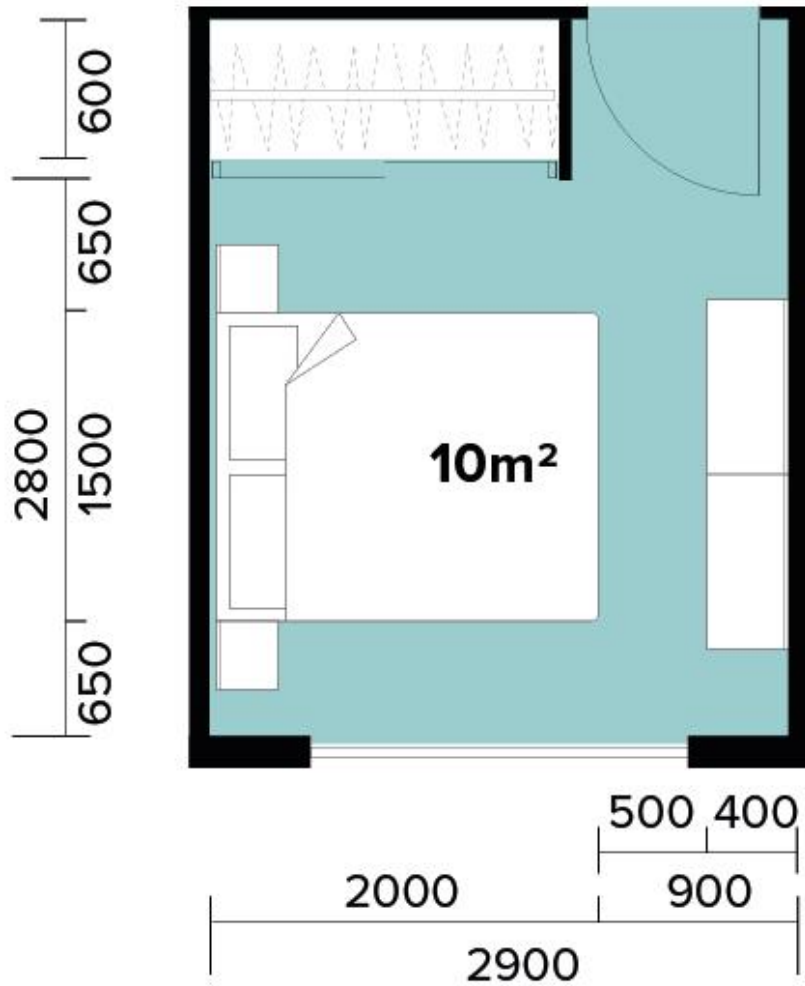

3.2m minimum dimension allows space for secondary furniture, and allows more flexibility of furniture layouts, as illustrated below:

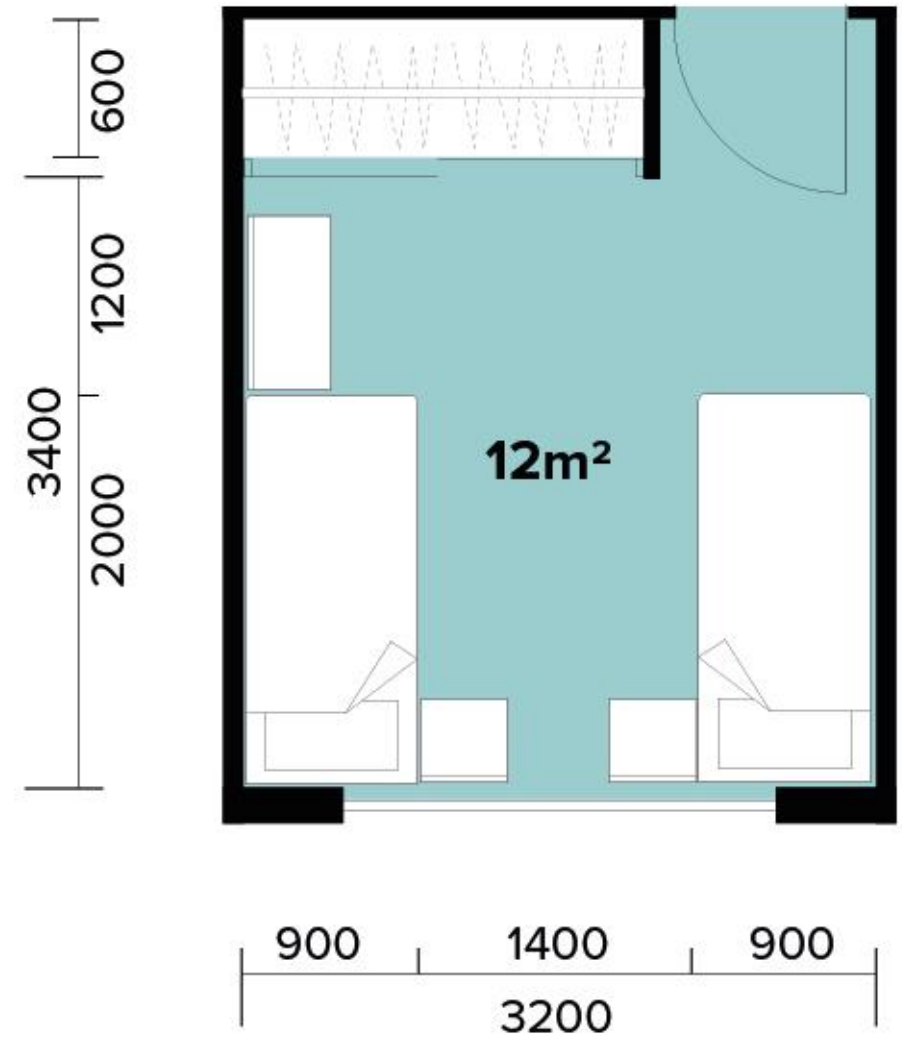
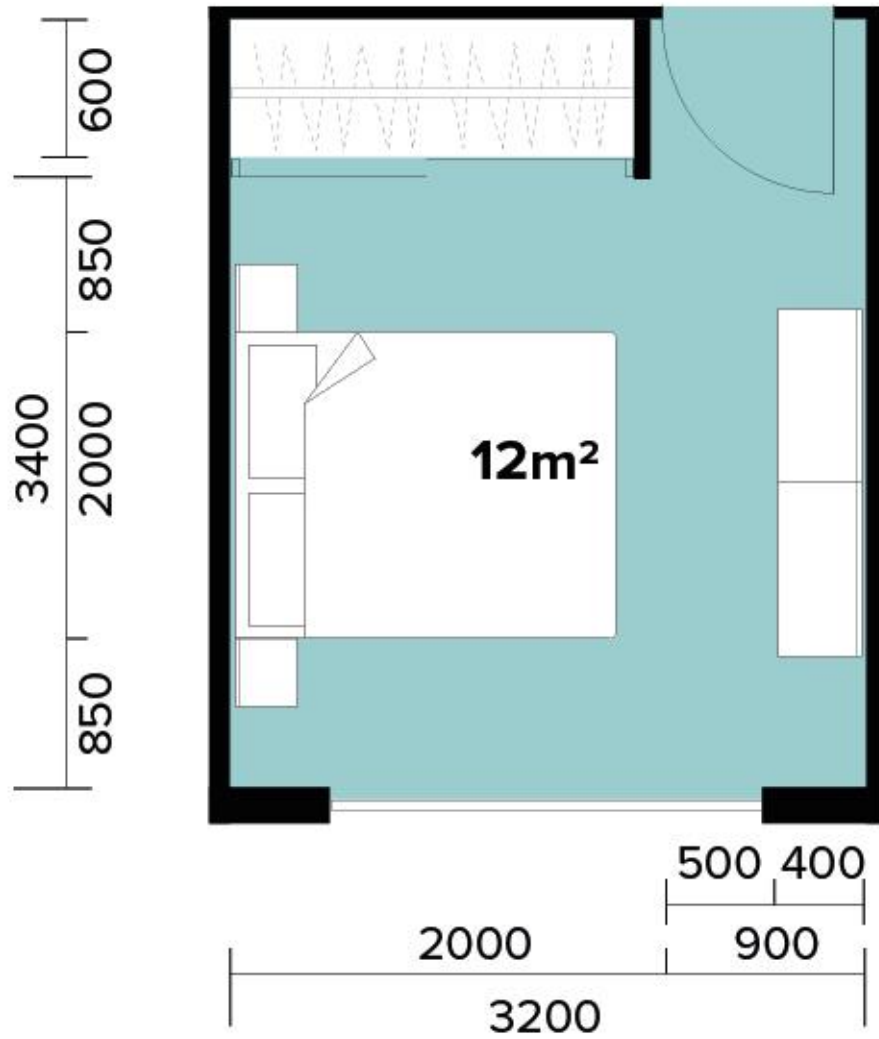

Small single bedroom layout

Typically used for space-efficient minimal individual or shared bedrooms.

So, minimum clearances of 30" or 76.2 cm and comfortable clearances of 36" or 91.4 cm are recommended around any open edge. In addition, bedrooms with small single beds should have minimum floor layout areas of around 86 sq. ft. or 8 sq. m.

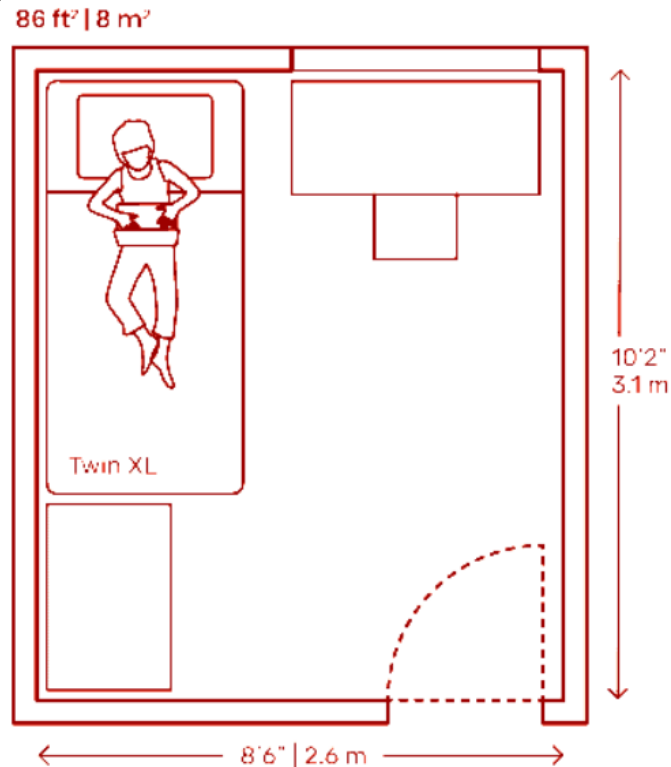

Full size double bedroom clearance layout

Minimum clearances of 30 inches or 76.2 cm and comfortable clearances of 36 inches or 91.4 cm are recommended around the perimeter of a double bed.

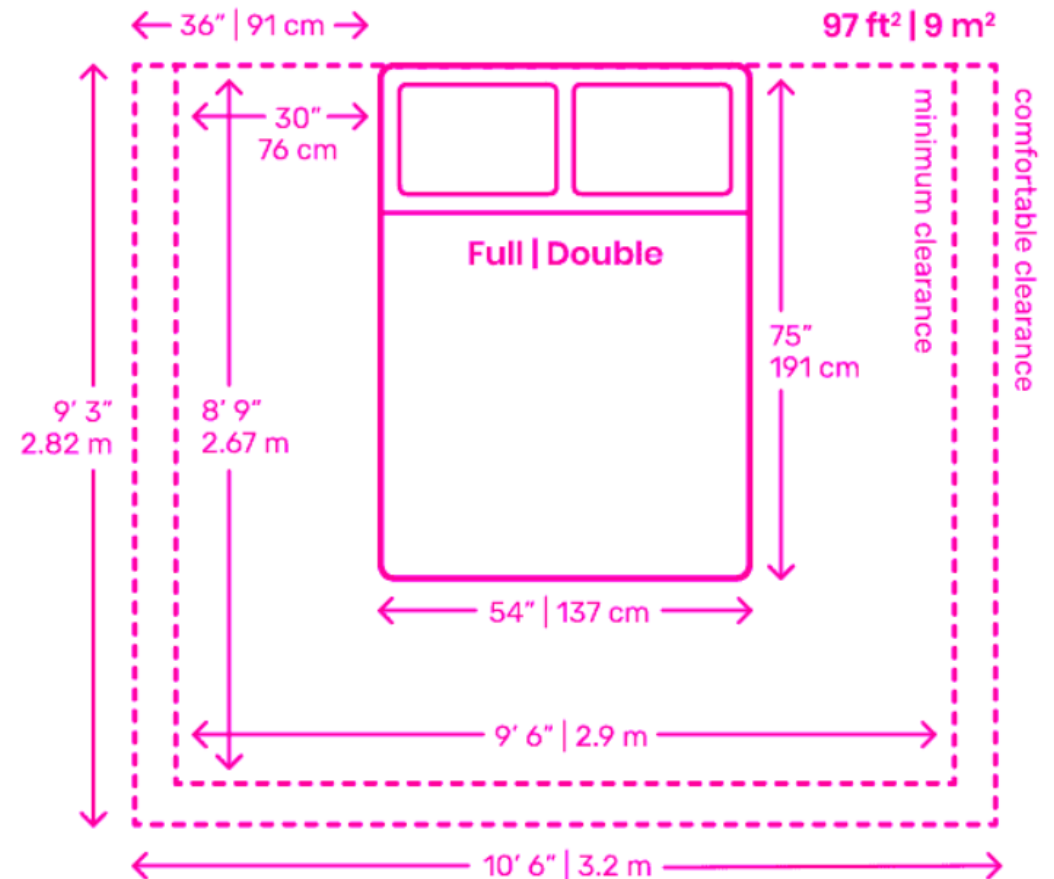

121 ft² | 11.2 m²

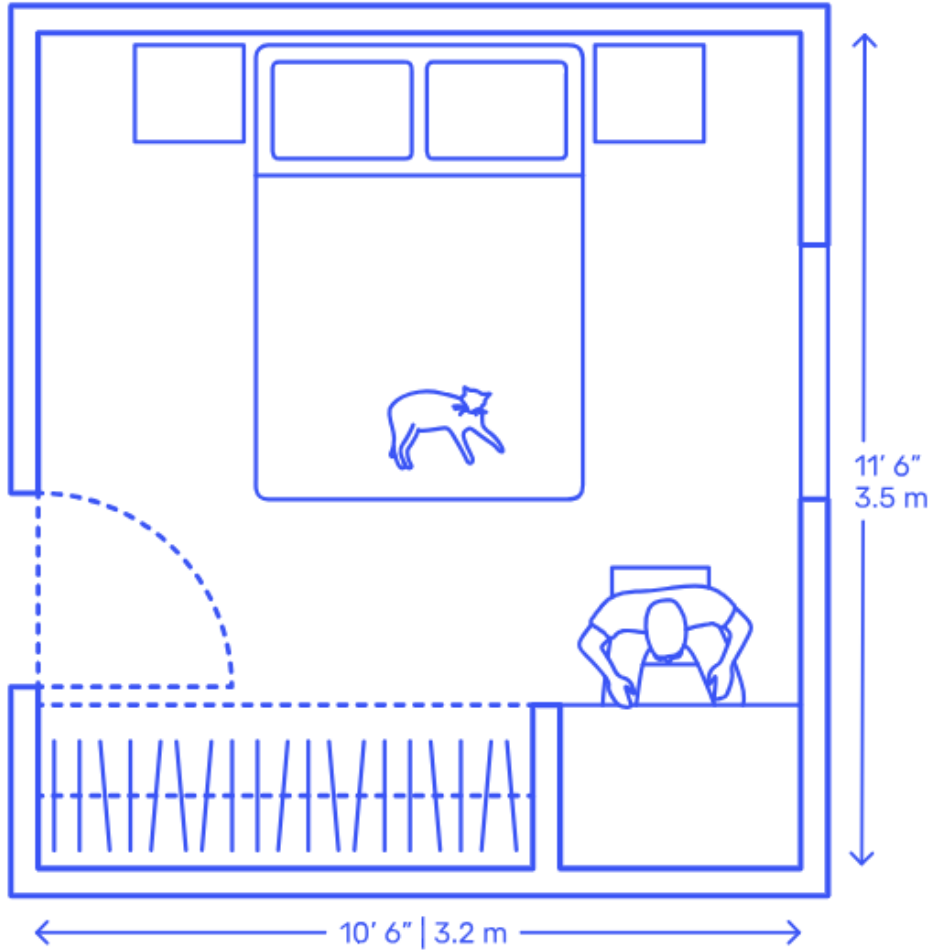

Double bedroom plan layout with front closet

118 ft² | 11 m²

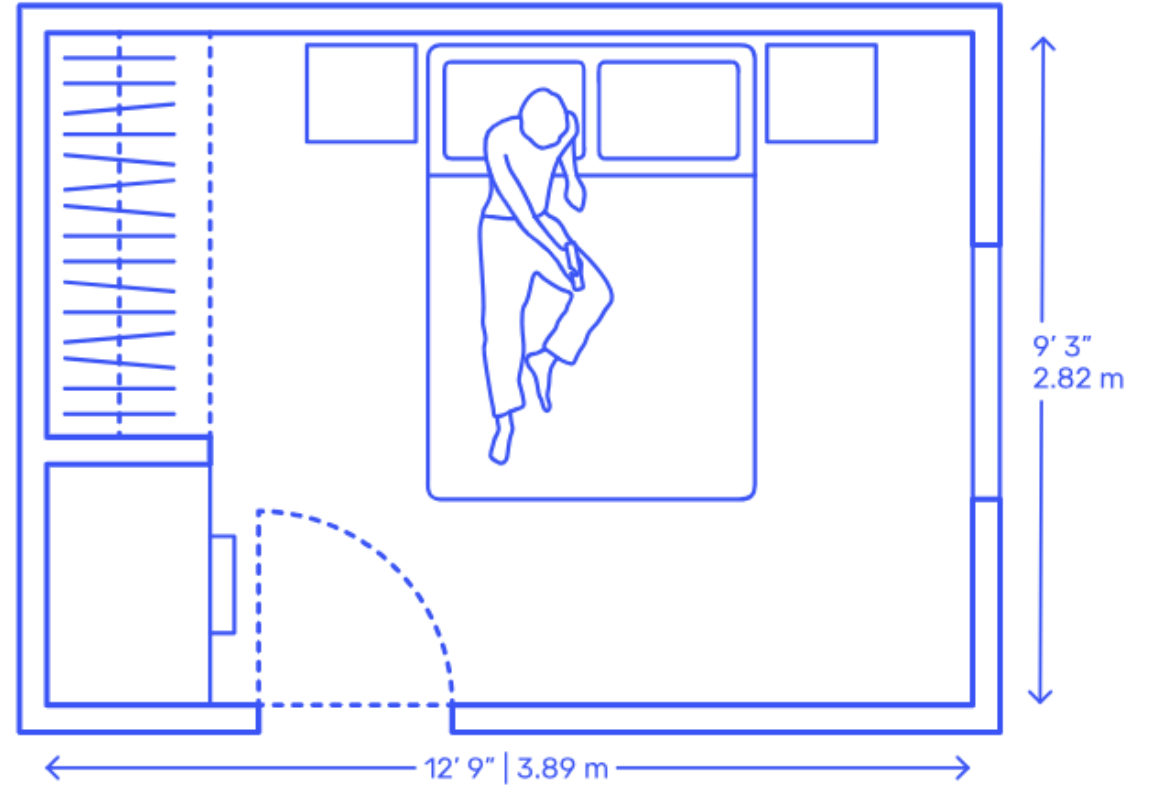

Double bedroom plan layout with side closet

- The bedroom layout should allow clearance of 26"-30" (66-76cm) around the bed. Clearance is important to allow bed-making and circulation around the bed.

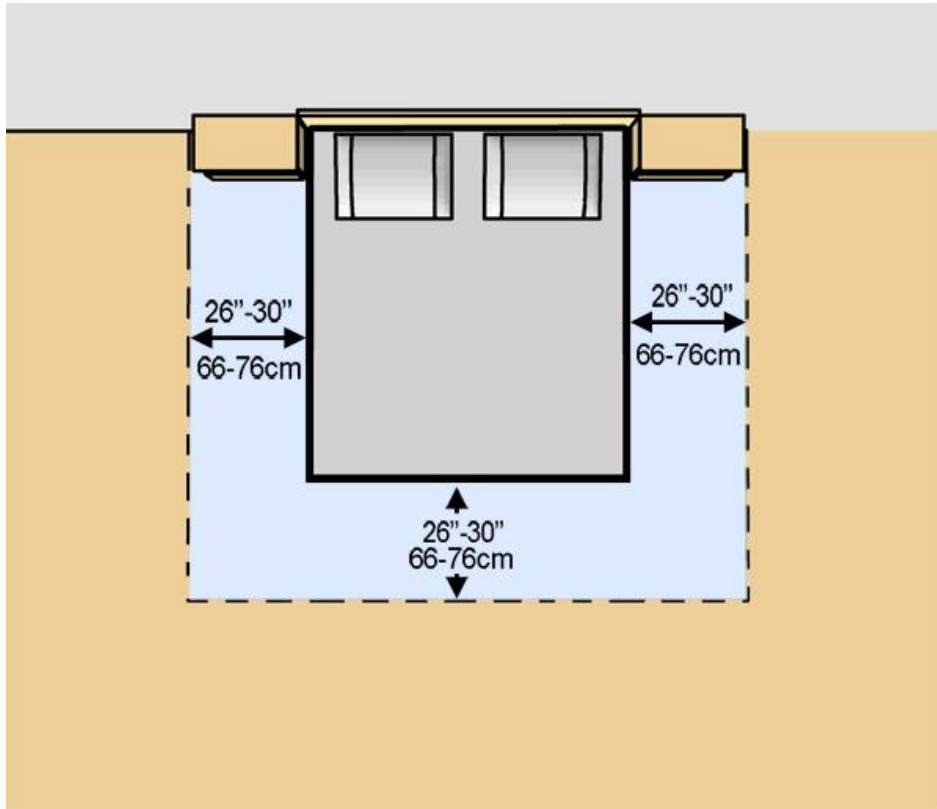

- If there is a wardrobe or chest standing parallel to the bed, allow a clearance of 36" (91,5 cm) between the end of the bed and the chest/wardrobe.

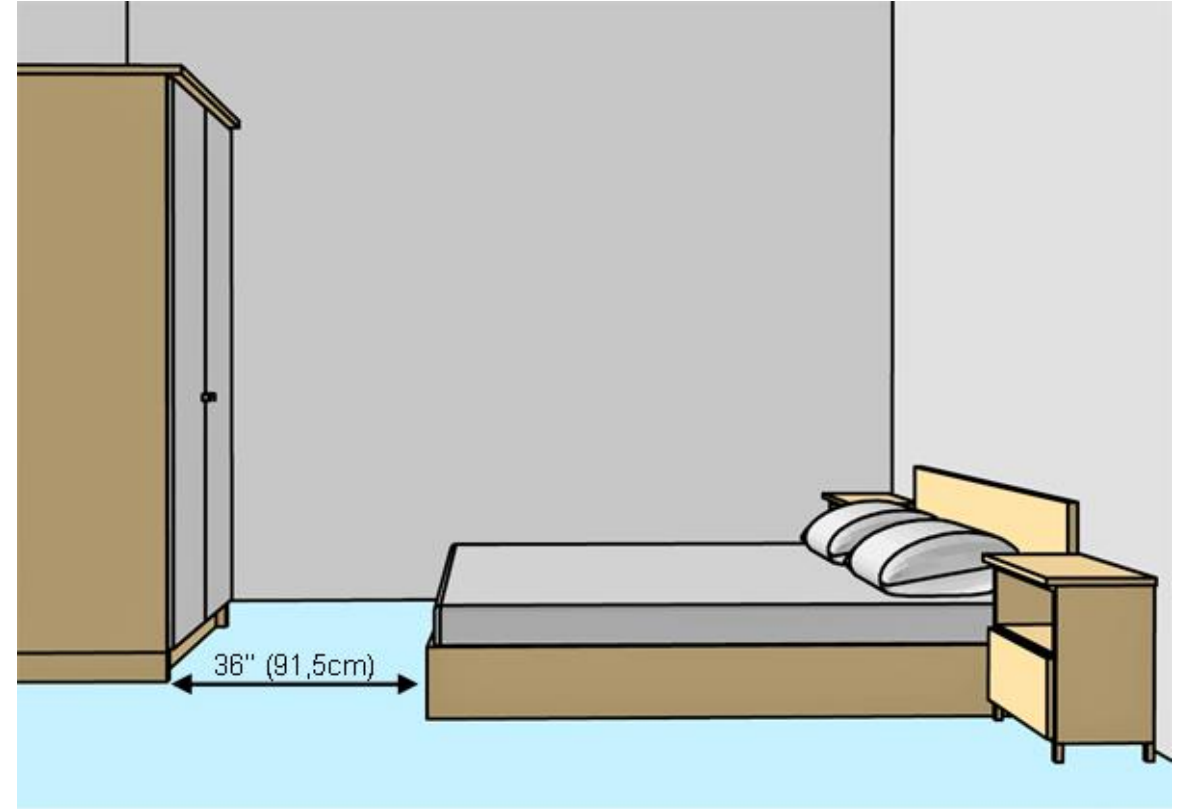

THANK YOU