

The National Museum of Qatar

HAWNAZ MAGID ABDULLA

14-12-2022

Background

The current building opened to the public on 28 March 2019, replacing the previous building which opened in 1975.

The museum welcomed more than 450,000 visitors in less than a year of its opening.

more than 8,000 square meters of exhibition the largest museum of local history on the planet. Over more than 52000m² land

A masterpiece by Jean Nouvel Its enveloping, volume and structure, on the other hand, has international ambition, and tries advance the nation's cultural vision on the global stage.

Concept

The building designed by [Jean Nouvel](#) evokes the crystallization of a desert rose (a mineral formation typical of the Persian Gulf region). The shape is highly scenography and wants to root a nomadic culture of pearl fishermen turned into lords of the energies of the twentieth century.

Jean Nouvel's project is, in the words of the architect, the materialization of what Qatar is: "a place of encounter between the sea and the desert".

Some became fishermen, others hunted for pearls.

[Jean Nouvel](#)

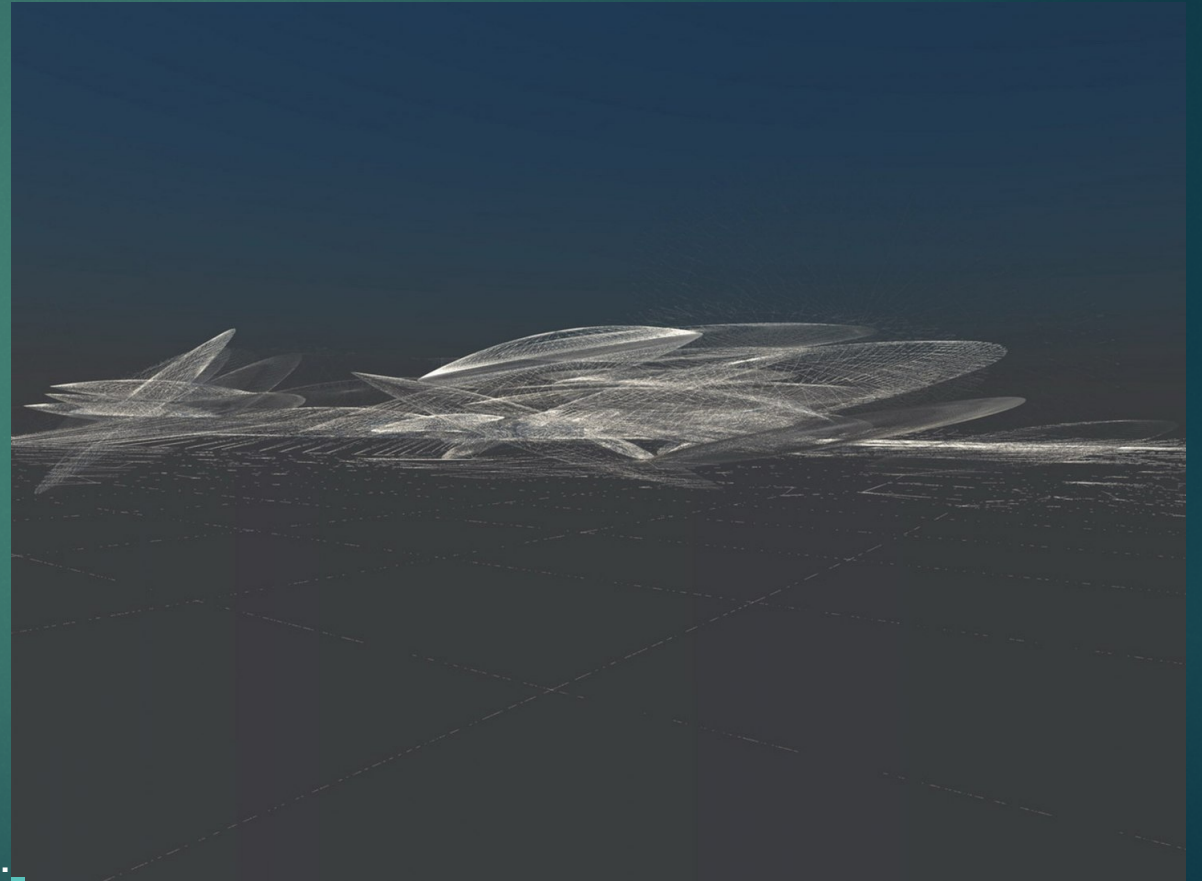



The inside gallery offers a journey through a series of unique, encompassing environments including architectural space, music, poetry, archaeological objects, artworks, monumentally-scaled art films, and more



The National Museum of Qatar represents the traditional geological and archaeological artifacts; of course tents, saddles and the dishes will bear witness to nomadic life; of course there will be fishermen's utensils, boats and nets.

Construction Structure As Architecture

The museum's architecture and structure symbolize the mysteries of the desert's concretions and crystallizations, suggesting the interlocking pattern of the bladelike petals of **the desert rose crystal** which is not a flower, but a mineral formation created by salt evaporation in the sand layer.

Construction tools

Contemporary construction tools (steel, glass and fiber concrete)

28,000 tonnes of steel to be exact, which is around four times the amount that was used to construct Paris' Eiffel Tower!

Plans

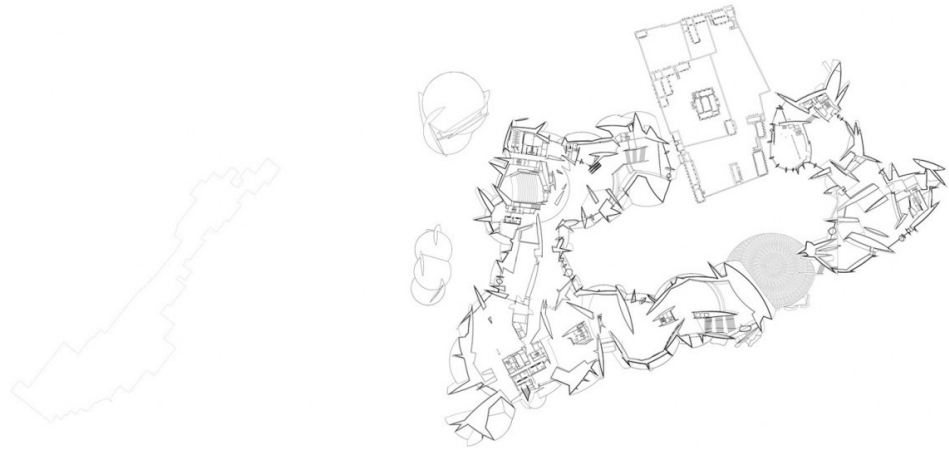

MASTERPLAN FIR

0 5 10 20 50

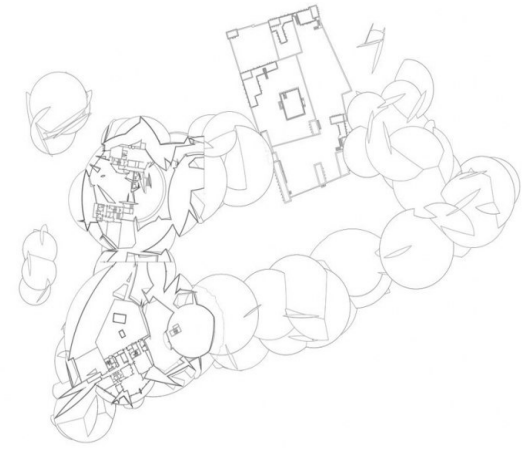
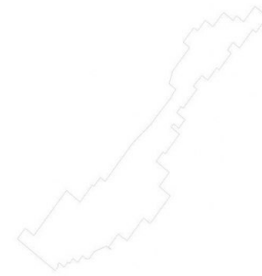

MASTERPLAN SECOND FLOOR

0 5 10 20 50 100