

**University of Salahaddin  
College of Engineering  
Department of Architecture**

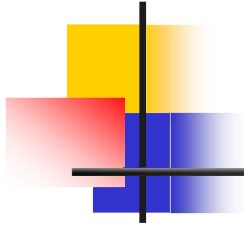

# **General Hospital**

# General Comments



## General comments

Nowadays a shift can be seen towards hierarchic increasing humanization of the facilities.

Modern hospitals tend to be rather like hotels in nature.



The length of patients stay is getting progressively shorter, and there is a growing preference for rooms with one or two beds (particularly for private patients.)



# General Comments

## Hospital types

Hospitals are divided by function into:-

- General, Specialist and university hospitals.
- Specialist hospitals are growing fast because of the increasing focus on individual types of treatment or medical fields.
- University hospitals with maximum provision are to be considered equal to the medical Academies (research and teaching) and some large general hospitals.



Hôpital Riviera-Chablais  
Bâtiment: Delcourt

Bâtiment: Delcourt  
100 000 m<sup>2</sup>  
(2000-2005)



Cancer Centre at Guy's  
London, UK

Bâtiment: Delcourt  
100 000 m<sup>2</sup>  
(2000-2005)



Center for Surgical Medicine, University Hospital Düsseldorf  
Düsseldorf, Germany

Bâtiment: Delcourt  
100 000 m<sup>2</sup>  
(2000-2005)



# General Comments

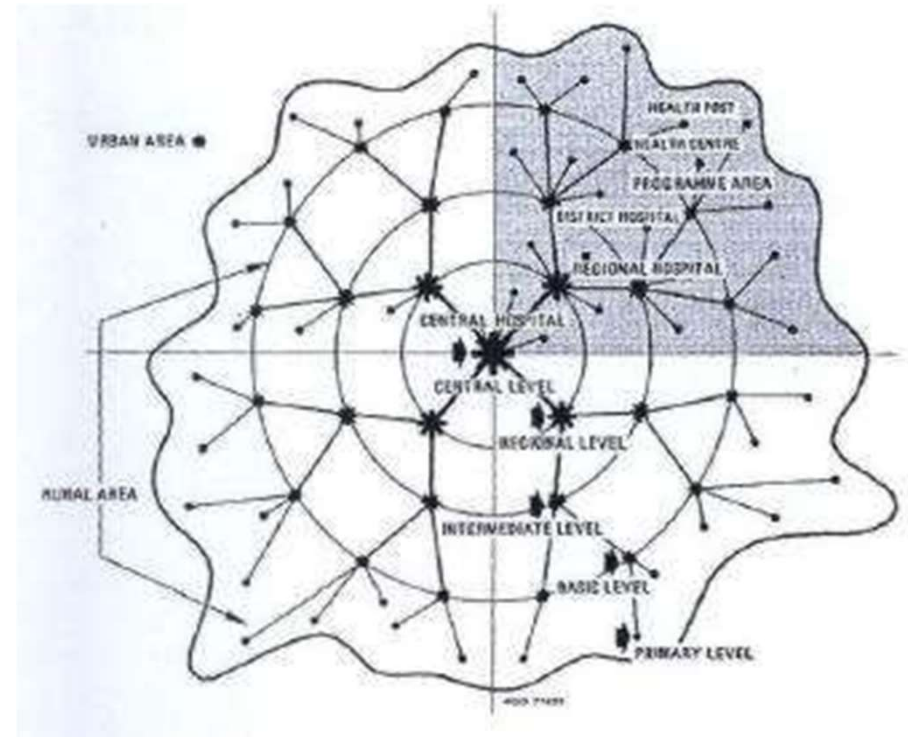
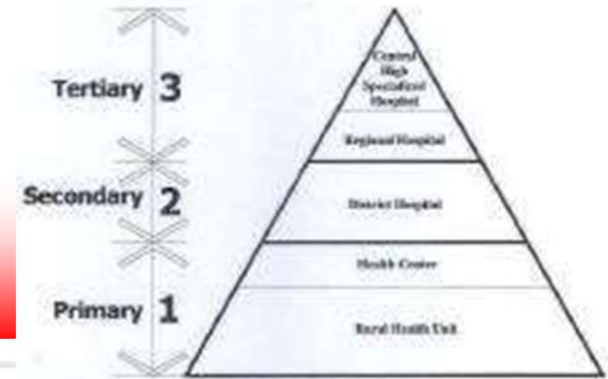

Pyramid Hierarchic For Health Care Buildings according to Health Care Levels

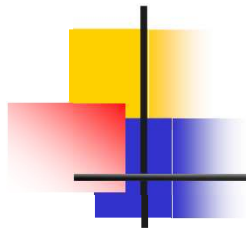

# General Comments



Milstein  
Family Heart Center  
New York-Presbyterian  
Hospital  
New York, New York, USA

Address	46 York Street & Duane St at 23rd St, New York
Client	NYU Langone Health
Completion	2015
Floor area	1,000,000 sq ft (93,000 sq m)
Program	Heart & Vascular Center (2015-2016)

1. Hospitals may be subdivided into the following categories:
  - a) smallest (up to 50 beds)
  - b) small (up to 150 beds)
  - c) standard (up to 600 bed)
  - d) and large hospitals (up to 1000 bed)



St. Olav's Hospital  
Trondheim, Norway

Address	St. Olavs Hospital N-7006 Trondheim
Client	St. Olavs Hospital
Completion	2010
Floor area	100,000 sq m (10,000,000 sq ft)
Program	General Hospital



Extension Kolding  
Hospital  
Kolding, Denmark



Address	St. Olavs Hospital N-7006 Trondheim
Client	St. Olavs Hospital
Completion	2010
Floor area	100,000 sq m (10,000,000 sq ft)
Program	General Hospital



Zaans Medisch  
Centrum  
Zaandam, the Netherlands



Address	Zaans Medisch Centrum Zaandam, the Netherlands
Client	Zaans Medisch Centrum
Completion	2010
Floor area	100,000 sq m (10,000,000 sq ft)
Program	General Hospital

# General Comments

## 2. According to the size of the medical specialists:

- a) Specialist hospital; pediatric hospital, eye hospital.. etc.
- b) General hospital; all medical specialists are provided.

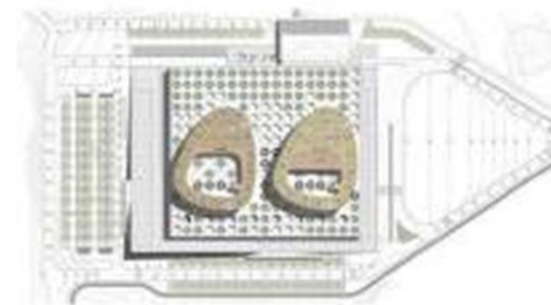

Theater floor plan

Theater floor plan



Juliana  
Children's Hospital  
The Hague, the Netherlands

Architect

MVSA Architects as part of  
the Vrije Universiteit  
Amsterdam



Entrance from the main building (2005) showing the main  
entrance (Access to emergency department)



Rey Juan Carlos  
Hospital

Madrid, Spain

Architect

Julian de La Pina

Client

City of Madrid  
Public Health Service



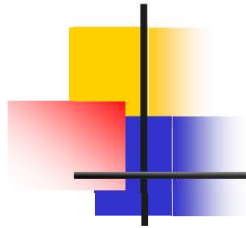

# General Comm



Max Levy/Chickenshire Architects Inc. © 2010



© 2010 CHICKENSHERE ARCHITECTS INC.

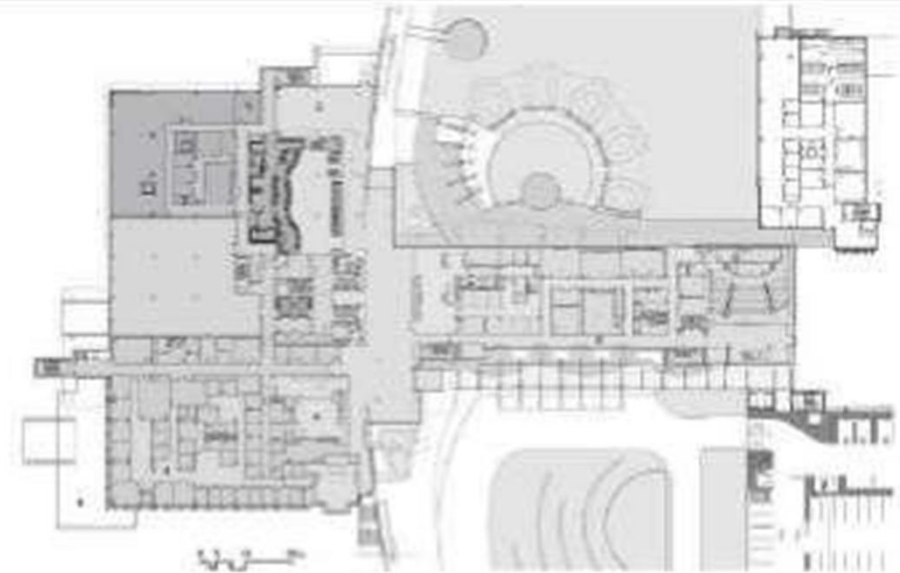

- 1 Library
- 2 Drinking
- 3 Adult + child lab
- 4 Parent space
- 5 Hall
- 6 Learning center
- 7 Data center



Nomours  
Children's Hospital  
Orlando, Florida, USA

Architect

Working: December 2008 - January 2010  
 Author: © 2010  
 Illustration: Perini Group

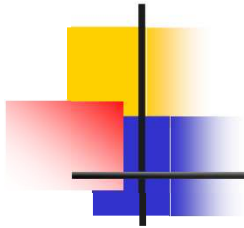

# General Comments

- 3. According to the owners of the hospital:
  - a) Private hospitals.
  - b) Public hospitals; university hospitals...



Site plan



East elevation



East section showing courtyard and entrance street



Private Hospital  
Villeneuve d'Ascq

Ulla Fritsen

Architect

Jean-François Poiroux  
Architects

Akershus  
University Hospital

Oslo, Norway

Architect

© Ulla Fritsen Architects