

**University of Salahaddin  
College of engineering  
Department of architecture**

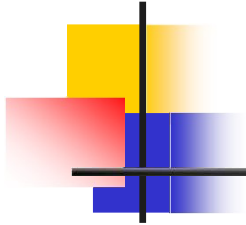

# **Laboratory Departments**

# Laboratory Department



## :Location

- Very close to the emergency department and external clinics
- Easily accessible from internal department
- Easily accessible from maternity and surgery departments
- Accessibility from central storages

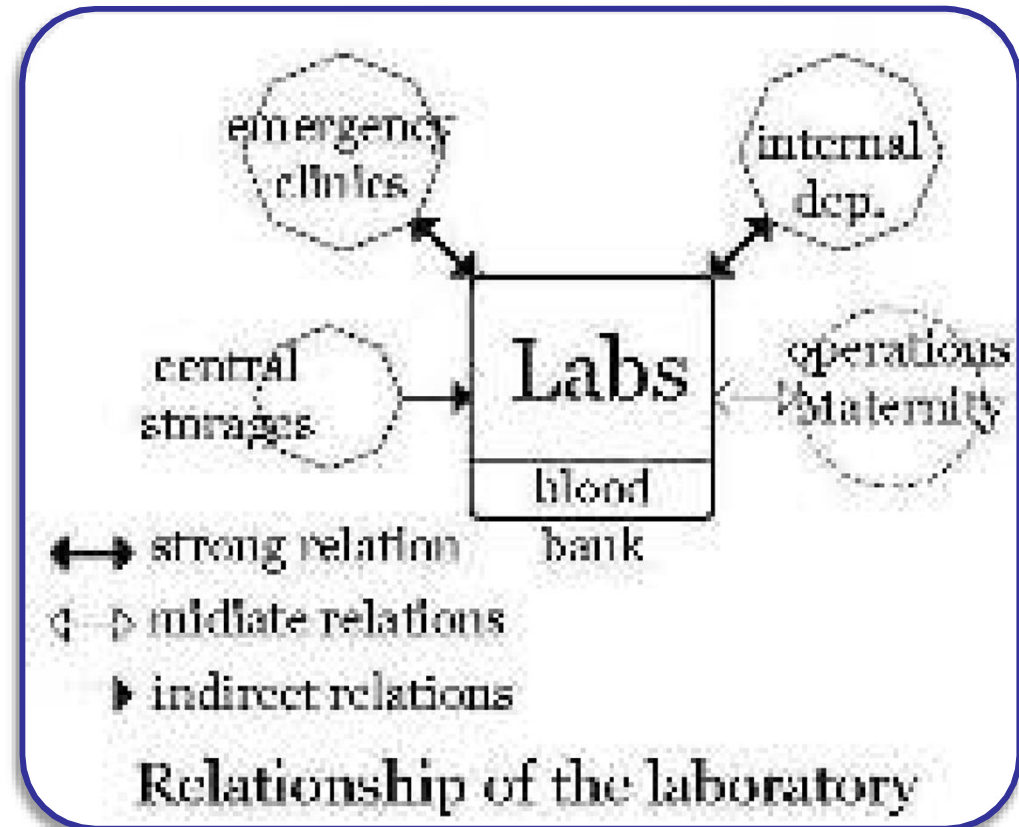

Relationship of the laboratory

# Laboratory Department



The four main laboratory disciplines in hospitals are:-

**Histology**

**Microbiology**

**Hematology**

**Biochemistry**

The **last two** may be **grouped together** as they can **share** much **automated equipment**

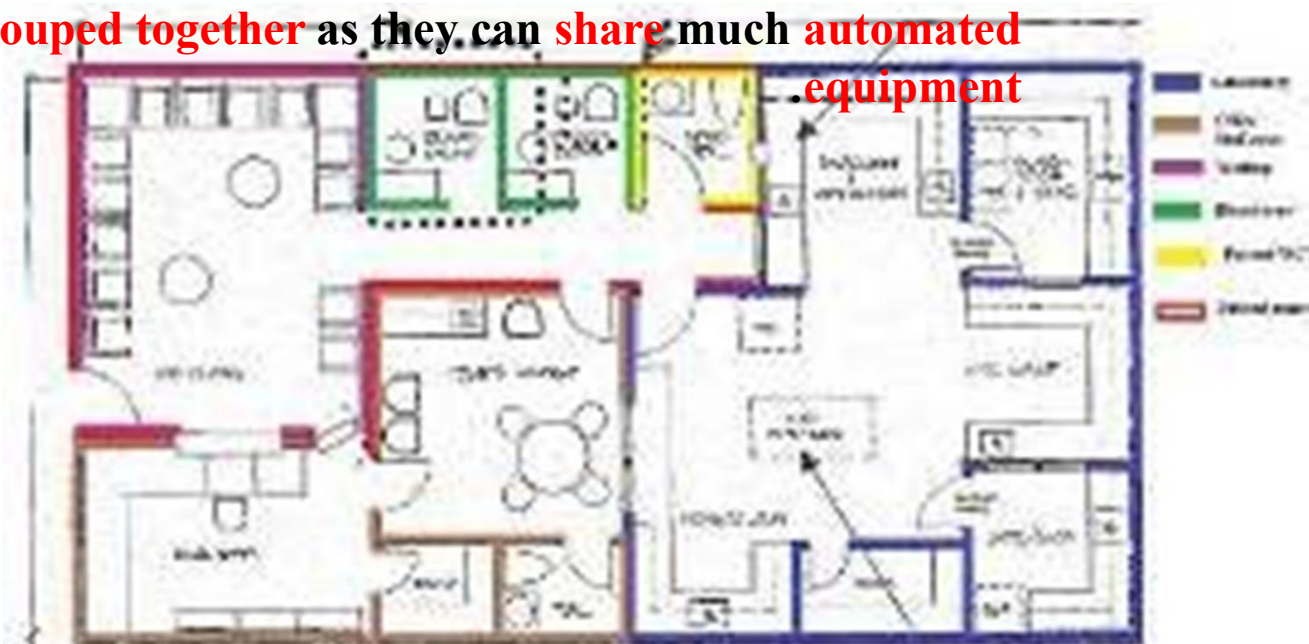

# Laboratory Department

The **whole department** will generally have a **shared receiving area for specimens and records**

**Ventilation and other safety standards** must meet current **legislation**

Laboratory

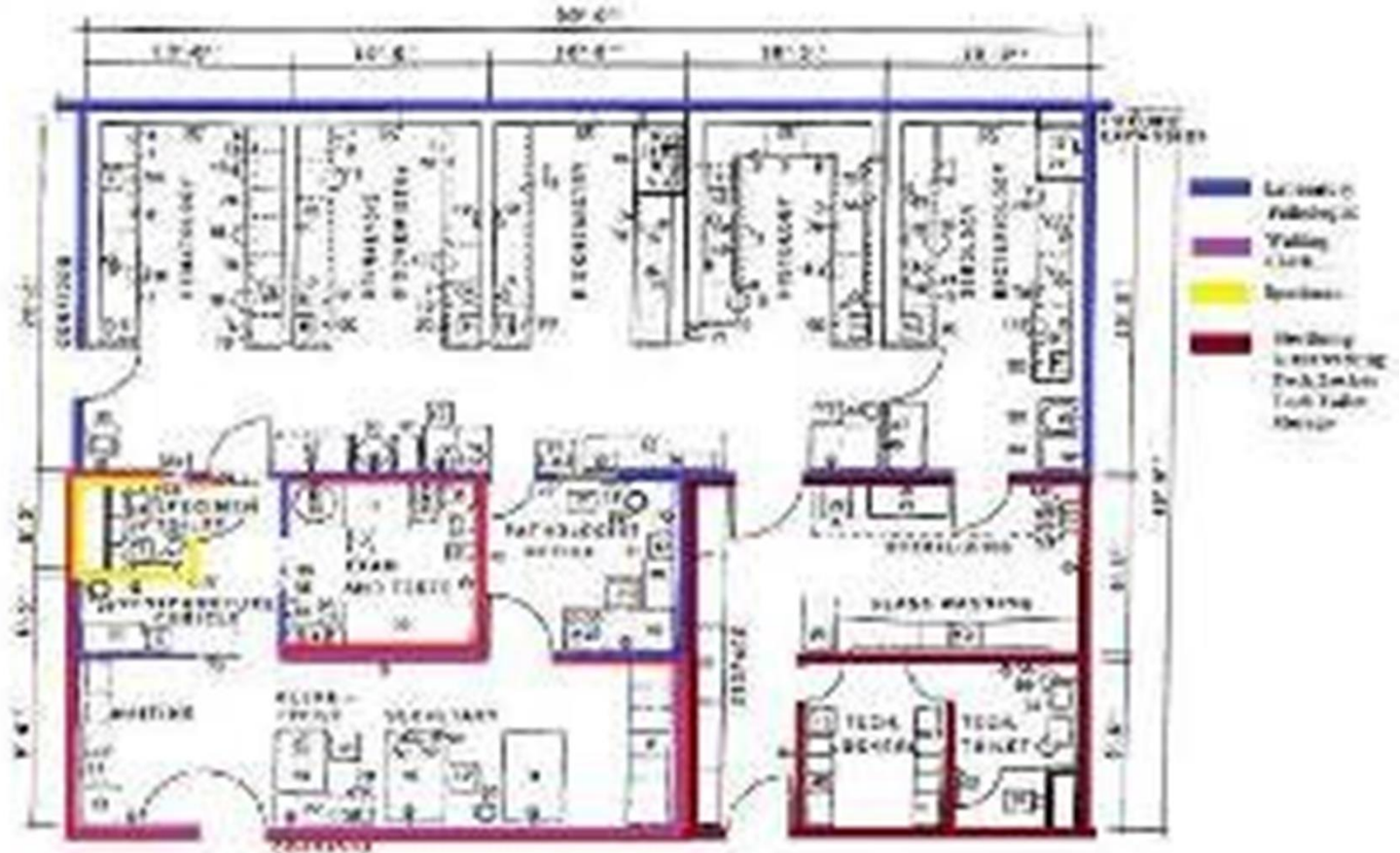



## Laboratory Department

The **laboratory** must be **located**  
**very close** to the **outpatient**  
**department** and **emergency**

**Easy access** from [ward, surgical,  
 .and **maternity** ]department

It **can be accessed** from the  
**central storage** of the hospital

